

TwinPoint Gen2
CATALOGUE



Folding door lock with internal and external access

centor®

Stainless steel handles - outward

Single	3
Double	4

Stainless steel handles - inward

Single	5
Double	6

Zinc handles

Single	7
Double	8
Spindle kit	8

Cylinders

Single	9
Double	10
Removable key/thumb turn	10

Lock bodies

	11
--	----

Transmission - wood

Rod and cover sets	12 - 13
Adaptors	14
Rod cups and plates	15

Transmission - hollow

Shims	16
Transmission rod set	16
Bolts and adaptors	16
Bolt guides	17

Stainless steel handles - outward opening

Single handle H01

Contents

1 x handle set, 1 x gasket, mounting screws

Non-keyed Short

20.5mm spindle depth

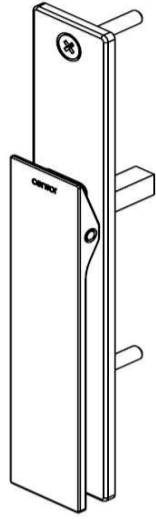

TPL-002-C-S	brushed stainless
TPL-002-C-OL	PVD black
TPL-002-C-TG	PVD brass

Keyed Long

20.5mm spindle depth

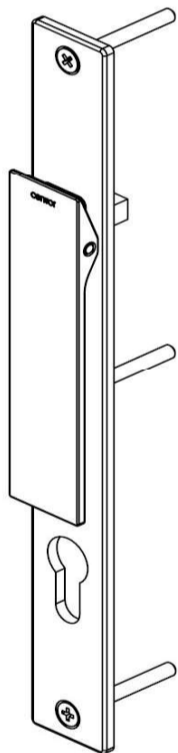

TPL-024-C-S	brushed stainless
TPL-024-C-OL	PVD black
TPL-024-C-TG	PVD brass

Stainless steel handles - outward opening (continue)

Double handle keyed, H01 Long

Contents

- 1 x internal handle set, 1 x external handle set*
- 2 x gasket, 3 x mounting screws*

16.5mm - 20.5mm spindle depth

TPL-001-AC-S	brushed stainless
TPL-001-AC-OL	PVD black
TPL-001-AC-TG	PVD brass

16.5mm - 24.5mm spindle depth

TPL-001-AE-S	brushed stainless
TPL-001-AE-OL	PVD black
TPL-001-AE-TG	PVD brass

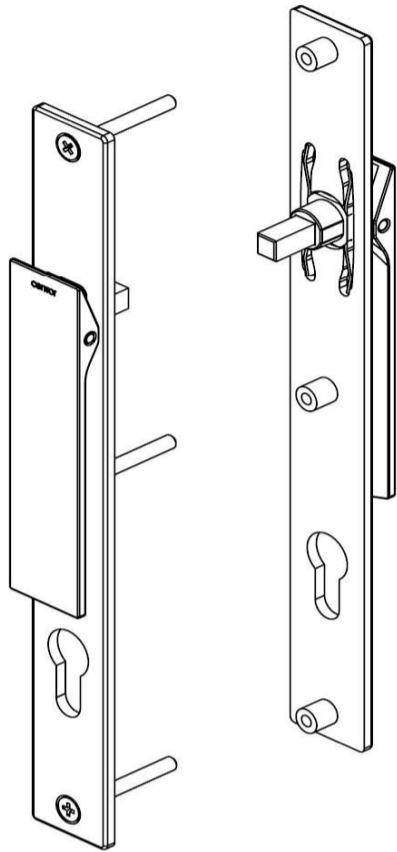

Stainless steel handles - inward opening

Single handle H01

Contents

1 x handle set, 1 x gasket, mounting screws

Non-keyed Short

20.5mm spindle depth

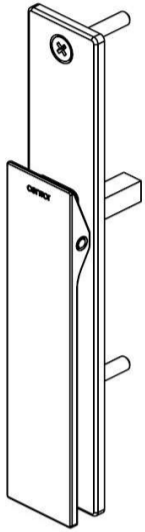

TPL-002-E-S	brushed stainless
TPL-002-E-OL	PVD black
TPL-002-E-TG	PVD brass

20.5mm spindle depth

TPL-002-G-S	brushed stainless
TPL-002-G-OL	PVD black
TPL-002-G-TG	PVD brass

Keyed Long

20.5mm spindle depth

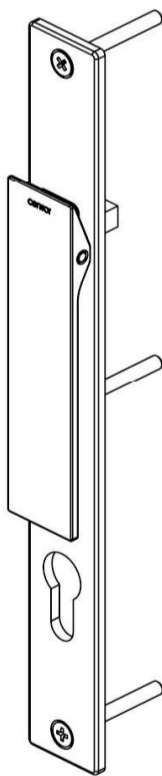

TPL-024-E-S	brushed stainless
TPL-024-E-OL	PVD black
TPL-024-E-TG	PVD brass

20.5mm spindle depth

TPL-024-G-S	brushed stainless
TPL-024-G-OL	PVD black
TPL-024-G-TG	PVD brass

Stainless steel handles - inward opening (continue)

Double handle keyed, H01 Long

Contents

- 1 x internal handle set, 1 x external handle set*
- 2 x gasket, 3 x mounting screws*

20.5mm - 16.5mm spindle depth

TPL-001-CA-S	brushed stainless
TPL-001-CA-OL	PVD black
TPL-001-CA-TG	PVD brass

24.5mm - 16.5mm spindle depth

TPL-001-EA-S	brushed stainless
TPL-001-EA-OL	PVD black
TPL-001-EA-TG	PVD brass

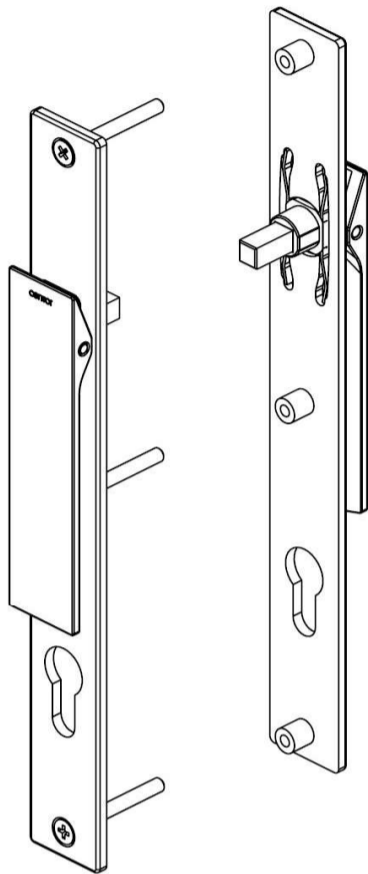

Zinc diecast handles

Single handle H02

Contents

1 x handle set, 30 & 35mm mounting screws

1 x 25 & 37mm spindles

2 x M4 spindle grub screw, 1 x 2mm allen key

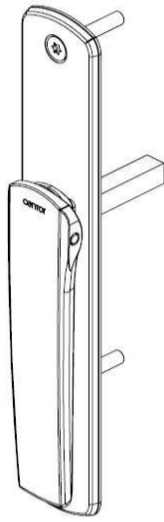

Non-keyed Short

TPL-055-01-NI	nickel plated
TPL-055-01-LM	black matt powdercoat
TPL-055-01-WM	white matt powdercoat

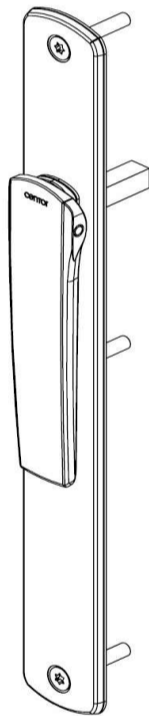

Non-keyed Long

TPL-056-01-NI	nickel plated
TPL-056-01-LM	black matt powdercoat
TPL-056-01-WM	white matt powdercoat

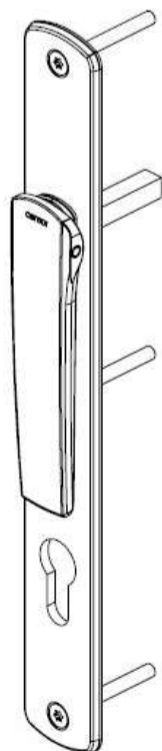

Keyed Long

outward opening - cover offset 7mm

TPL-057-01-NI	nickel plated
TPL-057-01-LM	black matt powdercoat
TPL-057-01-WM	white matt powdercoat

Zinc diecast handles

Double handle keyed, H02 Long

Contents

- 1 x internal handle set, 1 x external handle set*
- 3 x mounting screw sets (40, 45 & 50mm)*
- 3 x spindles (38, 42 & 46mm)*
- 2 x M4 spindle grub screw, 1 x 2mm allen key*

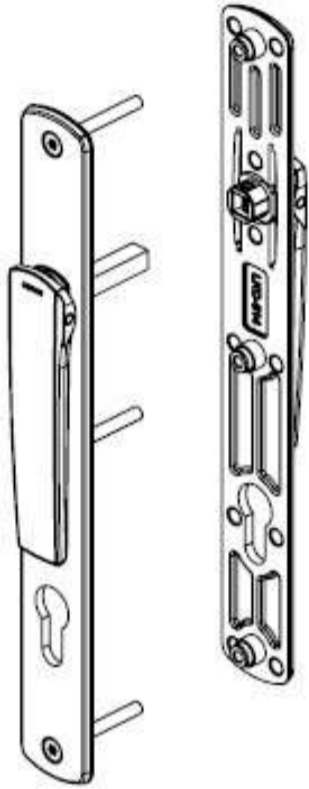

Keyed Long

TPL-054-01-NI	nickel plated
TPL-054-01-LM	black matt powdercoat
TPL-054-01-WM	white matt powdercoat

Spindle kit

Spindle kit 100mm

Contents

- 1 x 100mm spindle, 3 x 100mm mounting screws*
- 1 x M4 spindle grub screw, 1 x 2mm allen key*

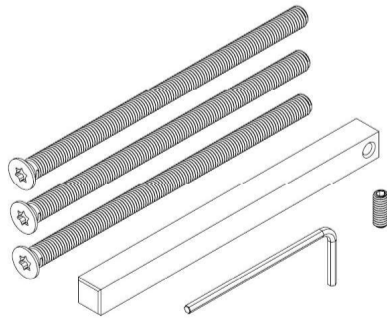

For non standard panels, cut spindle and screws to fit

TPL-058-100-S	stainless steel
TPL-058-100-OL	PVD black

Single lock cylinders

Lock cylinder Euro single C4

Contents

- 1 x cylinder, 3 x 5-pin key, 1 x 20mm long cylinder screw*
- 1 x Rehanding instruction*

3 pin 23mm

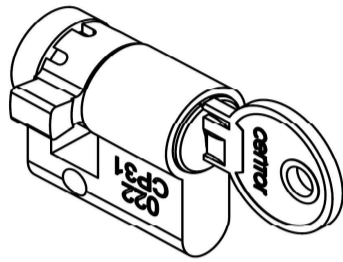

TPL-022-KA-US15	keyed alike	satin nickle
TPL-022-KA-MB		matt black
TPL-022-KA-TG		PVD brass
TPL-022-KD-US15	keyed different	satin nickle
TPL-022-KD-MB		matt black
TPL-022-KD-TG		PVD brass

5 pin 23mm

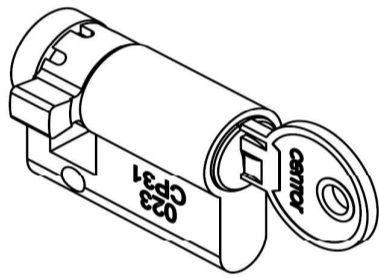

TPL-023-KA-US15	keyed alike	satin nickle
TPL-023-KA-MB		matt black
TPL-023-KA-TG		PVD brass
TPL-023-KD-US15	keyed different	satin nickle
TPL-023-KD-MB		matt black
TPL-023-KD-TG		PVD brass

Double lock cylinders

**Euro double C4 3/5 pin keyed special
Internal 3 pin keyed alike, external 5 pin keyed different**

Contents

*1 x cylinder, 2 x 3-Pin key, 2 x 3-Pin thumb turn, 2 x 5-pin key,
1 x 20mm long cylinder screw*

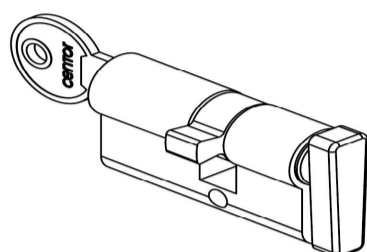

55mm (23-32) with removable thumb turn

TPL-036-L-KS-US15	left hand	satin nickle
TPL-036-L-KS-MB		matt black
TPL-036-L-KS-TG		PVD brass
TPL-036-R-KS-US15	right hand	satin nickle
TPL-036-R-KS-MB		matt black
TPL-036-R-KS-TG		PVD brass

Euro double C4 5/5 pin keyed different

Contents

1 x cylinder, 3 x 5-pin key, 1 x 20mm long cylinder screw

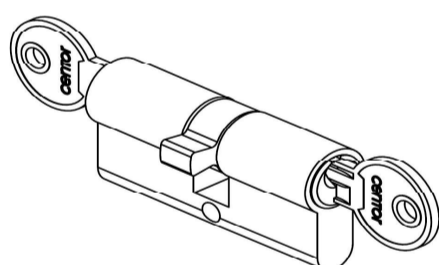

62mm (30-32)

TPL-021-L-KD-US15	left hand	satin nickle
TPL-021-L-KD-MB		matt black
TPL-021-L-KD-TG		PVD brass
TPL-021-R-KD-US15	right hand	satin nickle
TPL-021-R-KD-MB		matt black
TPL-021-R-KD-TG		PVD brass

Removable key/thumb turn

Key with thumb turn keyed alike C4

Contents

1 x thumb turn

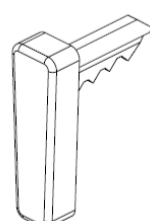

3 pin

TPL-037-KA-US15	satin nickel
TPL-037-KA-MB	matt black
TPL-037-KA-TG	PVD brass

Lock bodies

Lock body

Contents

1 x lock body

Non-keyed

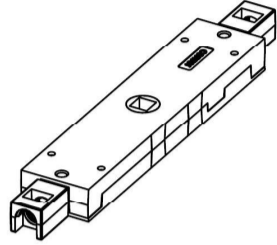

TPL-004

single short

Keyed

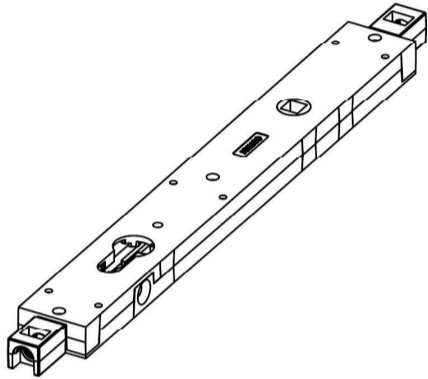

TPL-025

single long

TPL-003

double long

Transmission rod and cover sets - Straight bolt

Straight bolt - transmission rod set wood panels, quadrex

Contents

*1 x lock body cover, 2 x top & bottom covers same length,
2 x transmission rod with bolt attached (one short, one long),
4 x pop rivets, 1 x drill jig, 1 x screw pack*



up to 2440mm panel height

With hinge holes - access panel

TPL-029-24-XS	brushed metallic
TPL-029-24-Y	black

Without hinge holes - folding panel

TPL-043-24-XS	brushed metallic
TPL-043-24-Y	black

up to 3050mm panel height

With hinge holes - access panel

TPL-029-30-XS	brushed metallic
TPL-029-30-Y	black

Without hinge holes - folding panel no hinge holes

TPL-043-30-XS	brushed metallic
TPL-043-30-Y	black

up to 4000mm panel height

With hinge holes - access panel

TPL-029-40-XS	brushed metallic
TPL-029-40-Y	black

Without hinge holes - folding panel

TPL-043-40-XS	brushed metallic
TPL-043-40-Y	black

Transmission rod and cover sets - Offset bolt

Offset bolt - transmission rod set wood panels, quadrex

Contents

*1 x lock body cover, 2 x top & bottom covers same length,
2 x transmission rod with bolt attached (one short, one long),
4 x pop rivets, 1 x drill jig, 1 x screw pack*



up to 2440mm panel height

With hinge holes - access panel

TPL-026-24-XS	brushed metallic
TPL-026-24-Y	black

Without hinge holes - folding panel no hinge holes

TPL-042-24-XS	brushed metallic
TPL-042-24-Y	black

up to 3050mm panel height

With hinge holes - access panel

TPL-026-30-XS	brushed metallic
TPL-026-30-Y	black

Without hinge holes - folding panel no hinge holes

TPL-042-30-XS	brushed metallic
TPL-042-30-Y	black

up to 4000mm panel height

With hinge holes - access panel

TPL-026-40-XS	brushed metallic
TPL-026-40-Y	black

Without hinge holes - folding panel no hinge holes

TPL-042-40-XS	brushed metallic
TPL-042-40-Y	black

Transmission rod adaptors

Transmission rod adaptors

Contents

bag of 1 - 1 pair of rod adaptors

bag of 20 - 20 pairs of rod adaptors

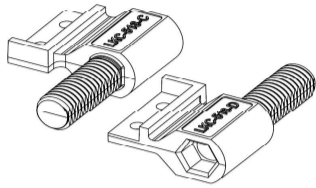

26mm backset

TPL-015-CD-01	bag of 1 set
TPL-015-CD-20	bag of 20 sets

40mm backset

TPL-015-EF-01	bag of 1 set
TPL-015-EF-20	bag of 20 sets

Bolt cups

Bolt cup kit 8mm

Contents

bag of 1 - 1 x bolt cup, 2 x mounting screws

bag of 20 - 20 x bolt cups, 40 x mounting screws

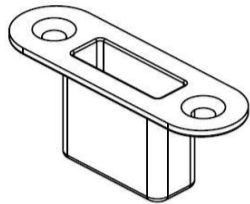

TPL-017-OL-01	bag of 1	PVD black
TPL-017-S-01		stainless steel
TPL-017-TG-01		PVD brass
TPL-017-OL-20	bag of 20	PVD black
TPL-017-S-20		stainless steel
TPL-017-TG-20		PVD brass

Strike plates

Strike plate kit 8mm

Contents

bag of 1 - 1 x bolt cup, 2 x mounting screws

bag of 20 - 20 x bolt cups, 40 x mounting screws

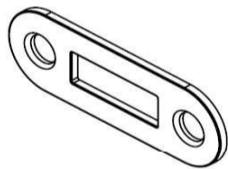

TPL-018-OL-01	bag of 1	PVD black
TPL-018-S-01		stainless steel
TPL-018-TG-01		PVD brass
TPL-018-OL-20	bag of 20	PVD black
TPL-018-S-20		stainless steel
TPL-018-TG-20		PVD brass

Shims

Shim

Contents
50 x shims

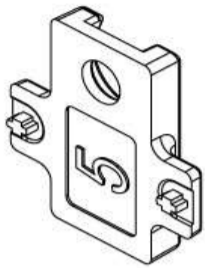

bag of 50

TPL-038-05-50	5mm
TPL-038-08-50	8mm
TPL-038-16-50	16mm

Transmission rod set

Transmission rod set

Contents
2 x transmission rods with

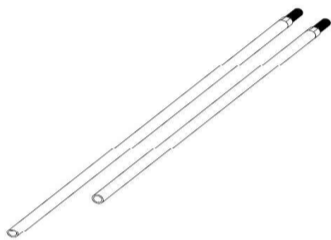

TPL-041-24	up to 2440mm panel height
TPL-041-30	up to 3050mm panel height
TPL-041-40	up to 4000mm panel height

Bolt guides

Bolt guide aluminium

Contents
bag of 2 - 2 x bolt guides, 4 x 8mm long screws
bag of 20 - 20 x bolt guides, 40 x 8mm long screws

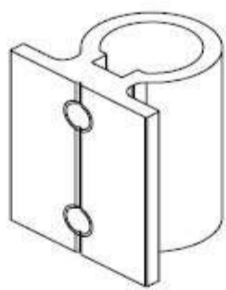

13.0mm ID - 13mm offset

TPL-034-NF-02	bag of 2
TPL-034-NF-20	bag of 20

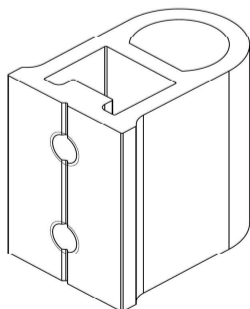

12.4mm ID - 20mm offset

TPL-035-NF-02	bag of 2
TPL-035-NF-20	bag of 20

Bolts and transmission rod adaptors

Rount bolt and adaptor

Contents

bag of 2 - 2 x bolts, 2 x adaptors (not attached)

bag of 20 - 20 x bolts, 20 x adaptors (not attached)

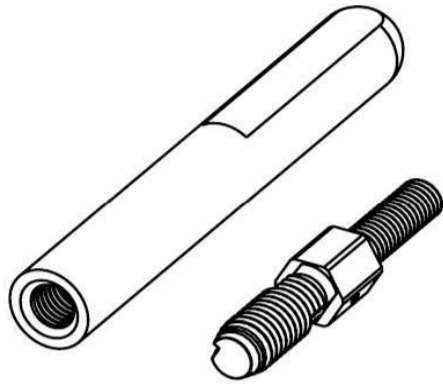

12.7mm single flat

TPL-033-B-02	bag of 2
TPL-033-B-20	bag of 20

12.7mm double flat

TPL-033-A-02	bag of 2
TPL-033-A-20	bag of 20

12.5mm single flat

TPL-033-C-02	bag of 2
TPL-033-C-20	bag of 20

12.0mm single flat

TPL-033-D-02	bag of 2
TPL-033-D-20	bag of 20

11.5mm single flat

TPL-033-E-02	bag of 2
TPL-033-E-20	bag of 20

Square bolt and adaptor

Contents

bag of 2 - 2 x bolts, 2 x adaptors (not attached)

bag of 20 - 20 x bolts, 20 x adaptors (not attached)

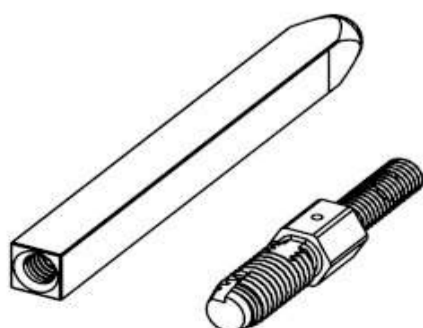

8mm

TPL-033-F-02	bag of 2
TPL-033-F-20	bag of 20

Centor Australia

1300 236 867

+61 7 3868 5777

mail@centor.com

centor.com